

Joslyn Clark's Compact CV Series Vacuum Contactors and Starters are ideal for tough industrial applications. The compact design provides flexibility for retrofitting air break contactors, thus enabling an existing application to continue with maintenance cost and down time eliminated.

These compact CV Series Contactors and Starters are suitable for worldwide applications and for use with all types of motors including high efficiency IEC and NEMA design E motors.

The CV Series are easily interchangeable with NEMA Air Break contactors & starters. This series also features a simplified DC magnet system with range rated economized coils for improved reliability.

International Ratings For Global Applications
 UL508 Listed | CSA22.2 certified | NEMA ICS-2 | IEC 947-4.1

Mechanically Interlocked versions are available for reversing applications.



Features

- Front Accessible
- Long Mechanical & Electrical Life
- Mounts in any plane
- Class 20 Bi-metallic overload relays
- Quiet, Rugged Design
- Standard with On/OFF Indicator
- Compact, Lightweight
- Side mounted auxiliary contacts



NEMA Size 5 Specifications

Catalog Numbers ¹	CV77U030506-**	CV77U034A06-**	CV77034A15-**
------------------------------	----------------	----------------	---------------

Power Ratings Enclosed			
Rated Insulating & Operating Voltage	600V	1,000V	1,500V
Rated Operating Current - AC1	270A	400A	400A
Rated Operating Power - AC3	200HP 460KW/575V	500HP 370KW-660V	850HP 650KW-1500V
Rated Operating Power - AC4	120HP 460KW/575V	300HP 260KW-660V	315HP 570KW-1500V
Rated Frequency	50-400Hz		
Making Current	4,000A		
Breaking Current	3,200A		
Dielectric Strength / B.I.L.	6,000V (1 Minute per Interrupter)		
Interrupting Current	4,600A		
Short Time Withstand Current (50ms)	18,000A		
Short Time Current (1s)	7,000A		
Short Time Current (10s)	3,200A		
Mechanical Life (No Load)	1,200,000 cycles		
Electrical Life at Rated Current (AC3 Duty)	1,000,000 cycles		
Switching Frequency	600 cycles per hour		
Chopping Current	0.9A		
Operating Range at Rated Voltage	-15% +10%		
Closing Power / Duration	1200VA 20ms		
Holding Power	10-12VA		
Average Opening Time	120ms		
Average Closing Time	20-40ms		
Average Pick-Up at Rated Voltage	≤85%		
Average Drop-Out at Rated Voltage	≤70%		
Recommended Control Transformer	500VA Machine Tool Transformer; 5% Regulation at 20%pf		

Application Ratings	
Mounting Installation	All Planes (Contactor only)
Altitude	Up to 6,600 feet (2,000 m)
Operating Temperature Range	-40°F (-40°C) +122°F (50°C)
Vibration / Shock	40Hz - 2G. / 30G.
Weight	30 lbs. (13.61 kg)
Auxiliary Contacts	1 N.C. & 1 N.O. (standard); 3 N.C. & 3 N.O. (optional)

Coil Voltages

Suffix	Coil Voltage
-76	110/120VAC 50/60Hz
-26	220/240VAC 50/60Hz
-125	125VDC
-150	250VDC

Motor HP/KW AC3

Voltage	270A	400A
200/208V	75/56	125/93
220/240V	100/75	150/112
380/415V	150/112	250/187
440V	200/149	250/187
460/480V	200/149	300/224
575V	250/187	350/261
600V	200/187	400/298
660/690V	-	450/336
1,000V	-	650/485
1,500V	-	1,000/746

Three Phase Transformer Load KVA

Voltage	270A	400A
200/208V	89/92	132/137
220/240V	98/107	145/158
380/415V	169/184	250/273
440V	195	290
460/480V	204/213	303/316
575V	255	378
600V	267	395
660/690V	-	434/454
1,000V	-	658
1,500V	-	987

Three Phase Transformer Load KVAR

Voltage	270A	400A
200/208V	66/68	98/102
220/240V	72/80	108/118
380/415V	126/138	186/204
440V	146	216
460/480V	152/160	226/236
575V	190	282
600V	200	296
660/690V	-	324/340
1,000V	-	492
1,500V	-	740

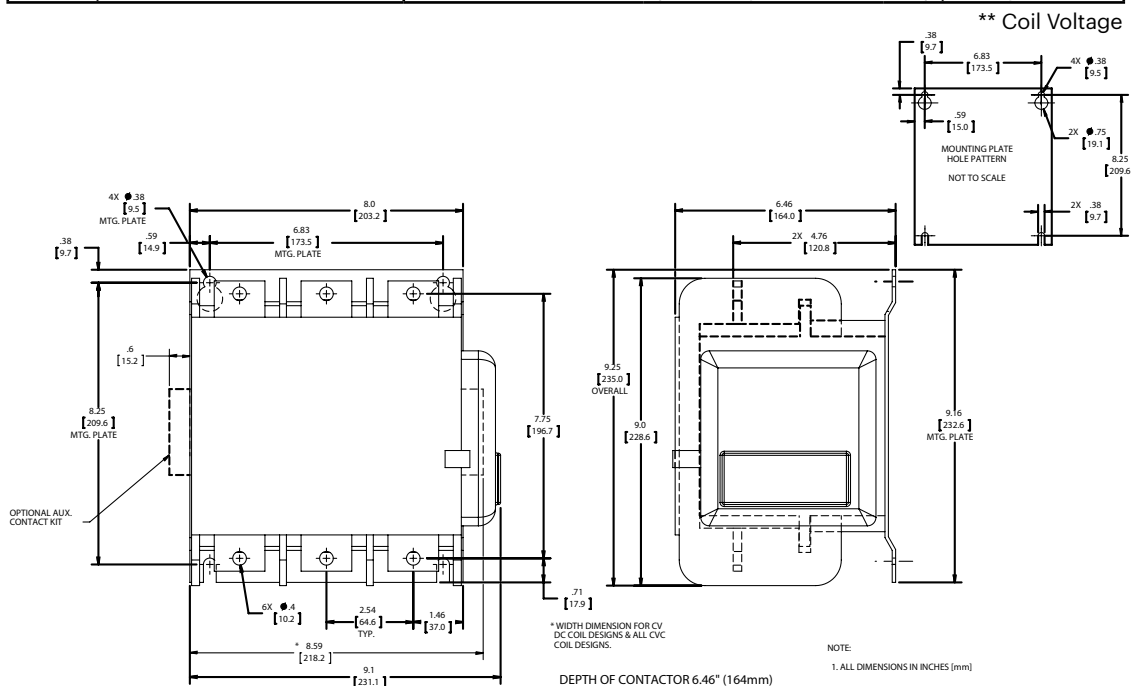

NOTES:
¹ Consult factory for certifications and approvals.